

House and Land Package

Lot 33 Edgewater Shores, Diamond Beach



PYCON
HOMES & CONSTRUCTIONS



The Hotham

\$657,680

234.2 4
SQ. Metres Bedrooms

2 2
Bathrooms Garages

Features

- Façade Upgrade - Urban
- Stone Kitchen Benches
- Laundry Joinery
- Gas Hot Water
- Floor Coverings Throughout
- Timberline Wall Hung Vanities
- Automatic Garage Door
- Free Standing Bath
- LED Downlights
- All Council & Certifying Fees
- Westinghouse appliances
- Mailbox & Clothesline

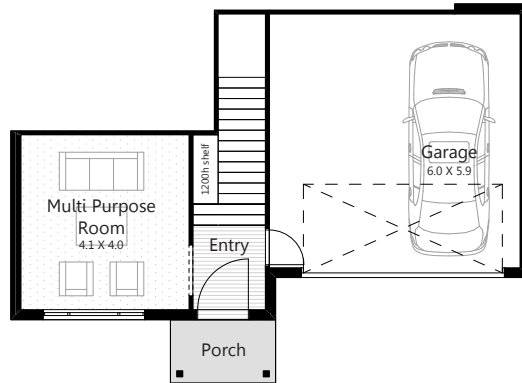

DISCLAIMER: Package based on a site works allowance and is subject to final reports. Photographs & illustrations are intended to be a visual aid only. Pycon Homes & Constructions gives no warranty and makes no representation to the accuracy or sufficiency of any description, illustration, photograph or statement contained in this brochure and accepts no liability for any loss suffered by any person who relies on either wholly or partly upon the information presented. All information is subject to change without notice. This package cannot be used conjunction with any other offer or promotion.

BUILT *different*
SINCE 1980